







Ponga

-  2 BEDROOMS
-  1 LIVING ROOM
-  2 TOILETS
-  1 BATHROOM
-  2 WALK-IN ROBES
-  1 ENSUITE
-  SEPARATE LAUNDRY

2 Bdrm / 124m²

Welcome to a compact, stylish home, with a raking ceiling. You'll enjoy the north facing elevation, with decking across the entire frontage. Indoor/outdoor flow is excellent, including living and bedrooms; and there's ample wardrobe space for guests.



Artist's Impression Only

KEY FEATURES OF THIS HOME

- Bevelback weatherboard and ply/batten cladding
- Open plan living
- Outdoor entertainment area
- Flexibility to be a transportable home

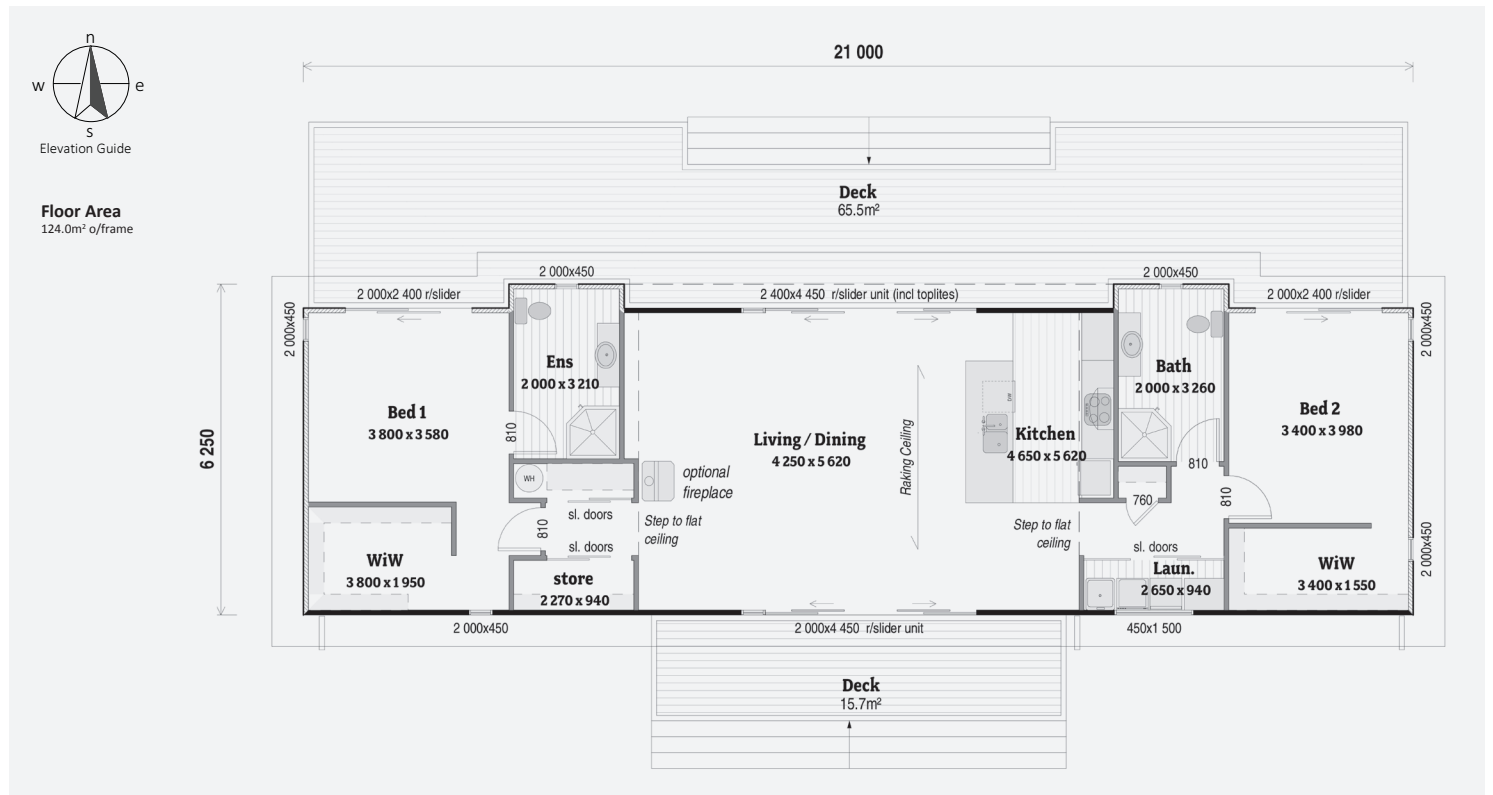



Floor Area
124.0m² o/frame

