

Tōtara

3 Bdrm / 238m²

Magnificent exterior appeal is just the start! Tōtara offers you an interior that's elegant as well as spacious, with separate areas for living and entertainment. If you run a business from home, you'll also appreciate the flexibility of the study configuration.



KEY FEATURES OF THIS HOME

- Brick veneer and weatherboard cladding
- Designa Schist columns
- Open plan living
- Protected laundry entrance
- Sheltered area outside dining room
- Triple garage

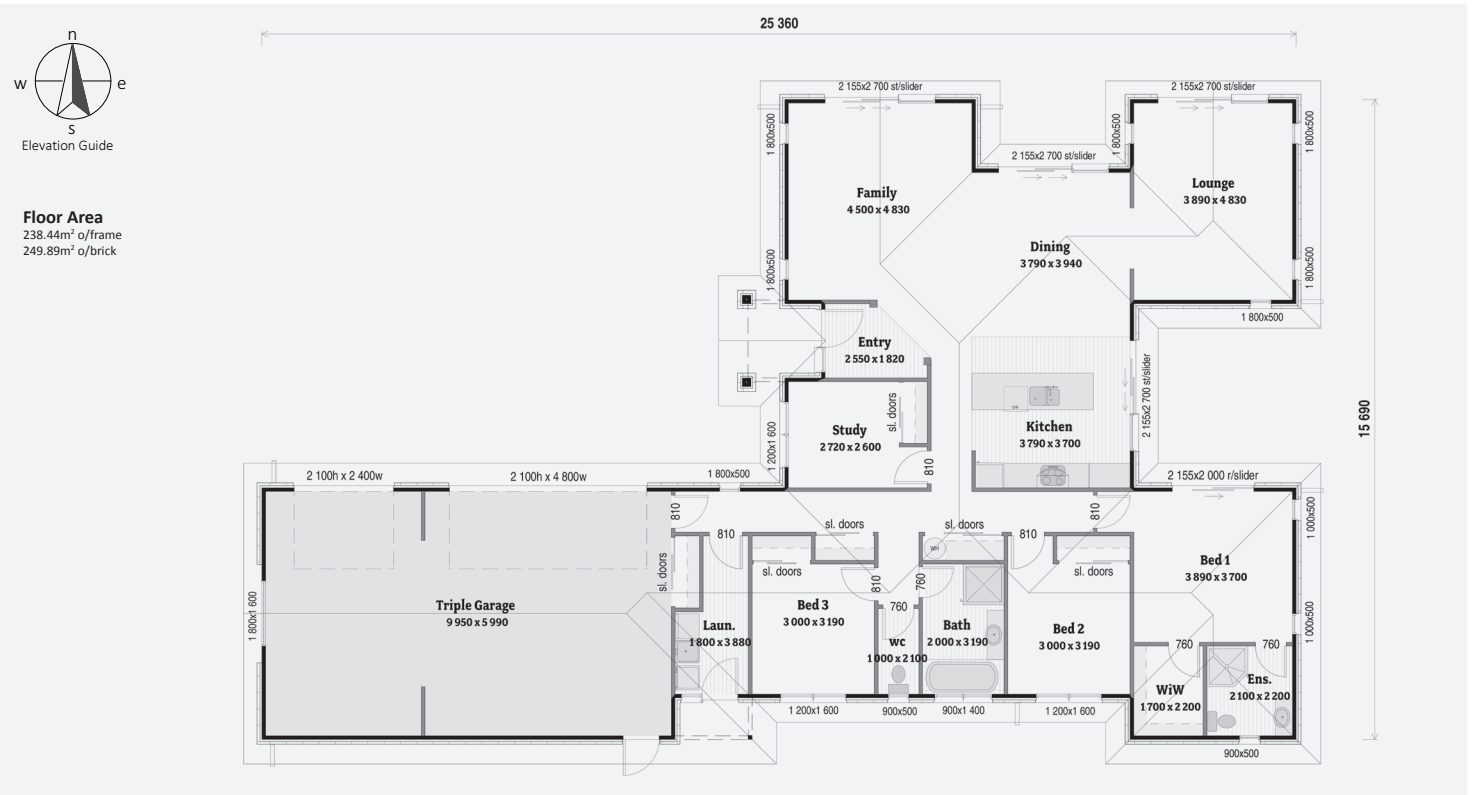



Floor Area
 238.44m² o/frame
 249.89m² o/brick

