

Kererū

3 Bdrm / 152m²

Your first home? An investment property? Downsizing? The compact, astute design of Kererū opens up your options. You have three bedrooms plus the potential to convert the study to a fourth bedroom.



KEY FEATURES OF THIS HOME

- Brick veneer and weatherboard cladding
- Open plan living
- Double garage

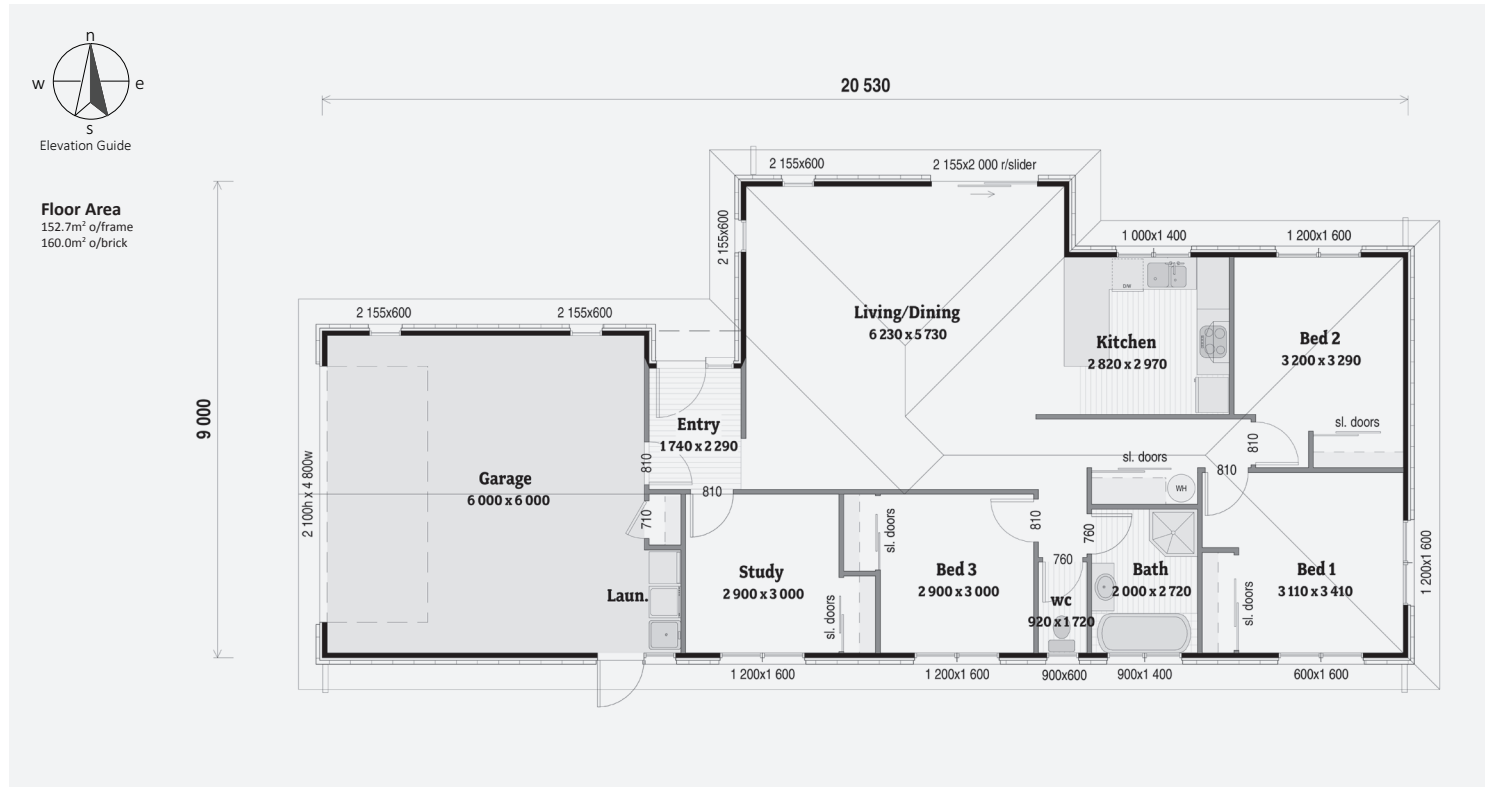

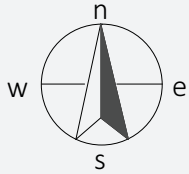

Elevation Guide

Floor Area
 152.7m² o/frame
 160.0m² o/brick

