









Fantail

3 Bdrm / 172m²

If you enjoy outdoor living and entertainment, discover Fantail. The north facing, sheltered space is perfect for casual alfresco dining. The family-sized bathroom gives you options for mobility access.

 3 BEDROOMS	 3 LIVING ROOMS	 2 TOILETS	 1 BATHROOM
 2 CAR GARAGE	 1 WALK-IN ROBE	 1 ENSUITE	 ✓ LAUNDRY



KEY FEATURES OF THIS HOME

- Brick veneer and weatherboard cladding
- Open plan living
- Double garage

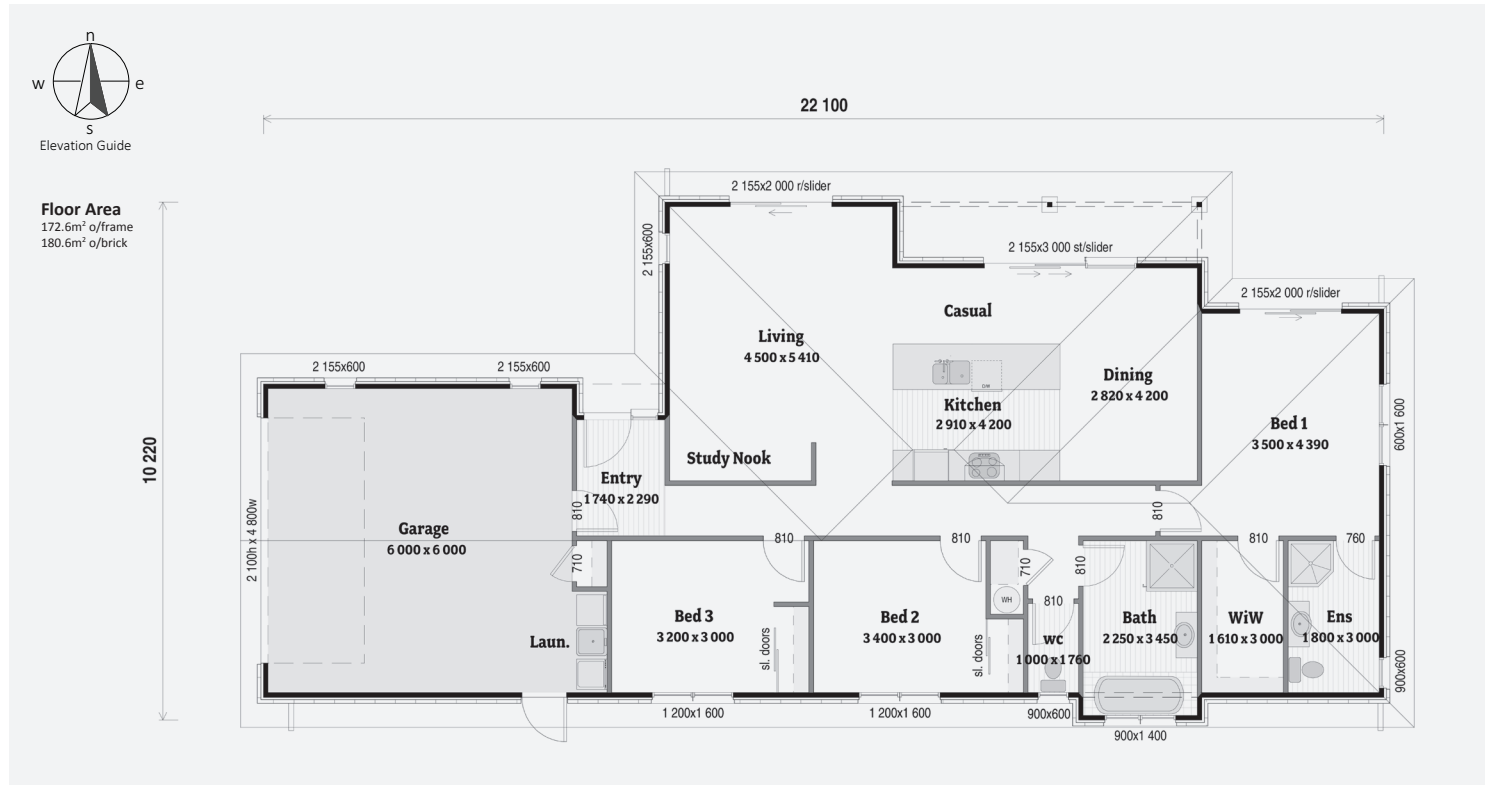

Always check the LBP Register to ensure your building practitioner is licensed.

Certified Plans are brought to you by New Zealand Certified Builders.

www.certifiedplans.co.nz



Floor Area
 172.6m² o/frame
 180.6m² o/brick

